

# SEALSTRONG

## Semi Rigid Polyurea Sealant

### INTRODUCTION

Sealstrong is new generation of semi-rigid sealant based on polyurea chemistry. It is a 100% solid, self-levelling and fast setting product which forms tough and flexible material after just few hours of application. The cured product can easily withstand mechanical shock, vehicular traffic, fork lift/ trolley movement, thermal expansion-contraction of the substrate without cracking or debonding.

### APPLICATIONS

- Filling control joints in the concrete floor
- Concrete penetrative pipe sealing
- Repairing of the moving surface crack on concrete for durable waterproofing

### KEY FEATURES

- 100% solid – no toxic vapour emission
- Fast setting – less downtime
- Good bonding with concrete, steel and roughened PVC surface
- Ultra high toughness
- Excellent crack bridging ability
- Good abrasion resistance
- High chemical resistance

### TECHNICAL DATA

Pot life	5-10 min
Tack free time	2-3 hours
Cure time	24 hours
Mixing ratio	3:1::A:B by weight
Mix density	1.2 g/ml (1200 Kg/cu.m.)
Bond strength	>3 MPa (concrete failure)
Tensile strength	>5 MPa (ASTM 412)
Max. elongation	>500 % (ASTM 412)
Tear Resistance	>60 N/mm (ASTM D624)

### APPLICATION PROCEDURE

#### Concrete penetrative pipe sealing

1. Concrete penetrative pipe can be sealed as per the system shown in the below image. It consist of two layers of non woven fleece reinforced Sealstrong membrane, one layer seal at the pipe surface while the other layer seal from the substrate side.
2. First prepare the surface properly. Clean the surface such that it is free from dust, paint, laitance, oil etc. Grind the concrete

3. surface surrounding pipe and roughen the pipe with emery paper.
3. Fill the gap between the pipe and concrete using Deck Micro Concrete such that the pipe is well fixed at its place. Allow it to cure for 24 hours.
4. Clean the surface and apply Deck Prime EP as per the application procedure given in its technical datasheet.
5. Repair the concrete surface (if required) using Deck Repair EP and allow it to cure.
6. Prepare the Sealstrong mix for fleece reinforced membrane application. Take a clean and dry container of suitable size. Empty Sealstrong part A and B completely in it and add 100 grams of Deck Thinner for 1 Kg of Sealstrong. Mix it using a low RPM (300-400 RPM) hand-held stirrer till a homogeneous liquid is obtained (generally it will take 1-2 min).
7. Apply the Sealstrong mix on the concrete substrate and pipe using brush.
8. Soak both the fleece layer properly with the prepared Sealstrong mix.
9. First place the fleece layer extended over the pipe surface as shown in the figure.
10. Then place the second layer. Apply Sealstrong mix (if required) to saturate both the layer of fleece properly.
11. Make sure there is no air pocket left between the fleece and pipe/ concrete surface.
12. Allow the system to cure for 24 hours before further application.

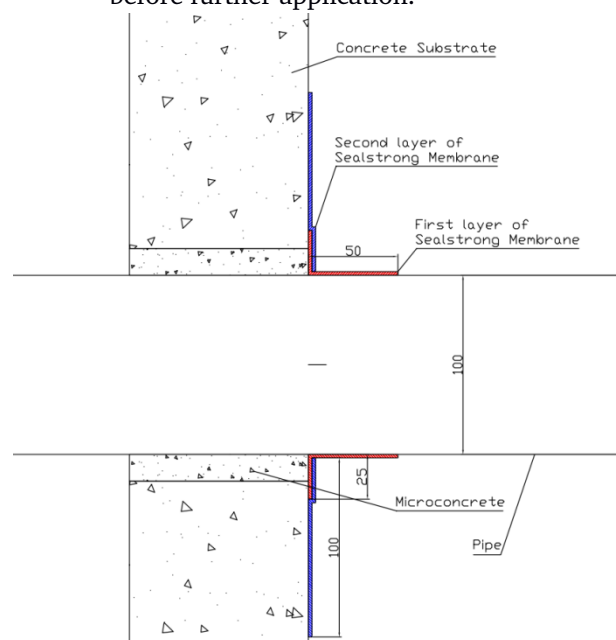

Figure 1: Schematic for Concrete Penetrative Pipe Sealing

### **Control joint and surface crack filling**

1. The joint/ gap must be free from any dust, debris, oil and water.
2. Concrete surface crack must be opened in 'U' shape having width and depth of 10 mm approx.
3. Just prior to filling carefully clean remove dust using air blower or vacuum cleaner.
4. Prepare Sealstrong mix, empty completely Part B in the Part A container and mix it using low RPM jiggy mixture.
5. Pour the mixture in the joint/ gap/ crack. The joint/ gap/ crack must be filled up to full depth.

### **PACKAGING**

Sealstrong Part A – 750 g

Sealstrong Part B – 250 g.

### **STORAGE**

Store in the original container with the lid closed appropriately. Avoid extreme temperatures and direct exposure to sunlight. Keep in cool, dry and under shed. Sealstrong performs well for at least 6 months from the date of manufacture if stored following aforesaid method.

### **HEALTH AND SAFETY**

Kindly wear hand gloves and safety goggles while handling the product. Any contact with eyes should be washed immediately with clean water and seek medical advice. Do not swallow. Avoid contact with food or cooking utensils and keep away from children's reach. If splashed on to cloth or any other fabric, wash immediately otherwise it may leave permanent stain.

### **PRODUCT DISCLAIMER**

*This product is manufactured with utmost care and precautions using best available materials, techniques and keeping in view the end use and assured performance. However, no specific guarantee can be given since the application of the product (prevailing site and environmental conditions while applying etc.) is beyond our control. We therefore welcome consultation in the event of doubt about application performance.*